

STEP 1

Purchase BNB coin

Purchase Binance Coin (BNB). BNB is available at the following exchanges*:



*availability will depend on your region, KYC may be required.

STEP 2

Install MetaMask

Download MetaMask for desktop, android or iOS. Follow the installation instructions*, once setup MetaMask will automatically create a wallet linked to the Ethereum smart chain.

<https://metamask.io/>



*ensure that your seed phrase is carefully stored offline.

STEP 3

Configure MetaMask

MetaMask needs to be configured for Binance smart chain (BSC) in order to send/receive and view your wallet balance in BNB and BEP20 tokens.

Step 1. Enter the settings menu for MetaMask

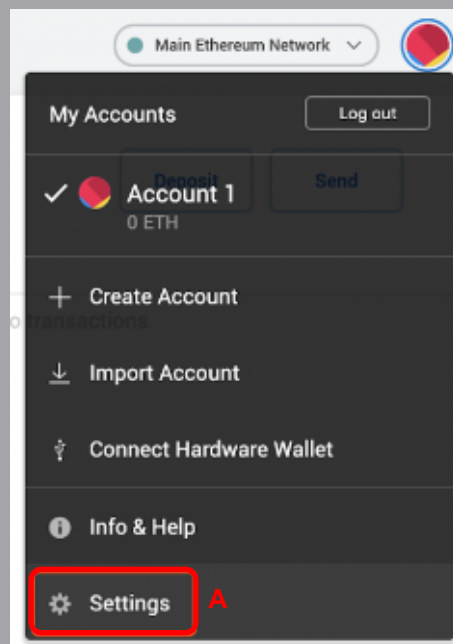

Continues on next page...



Step 2. In the settings menu select “Networks” and then select “Add Network”

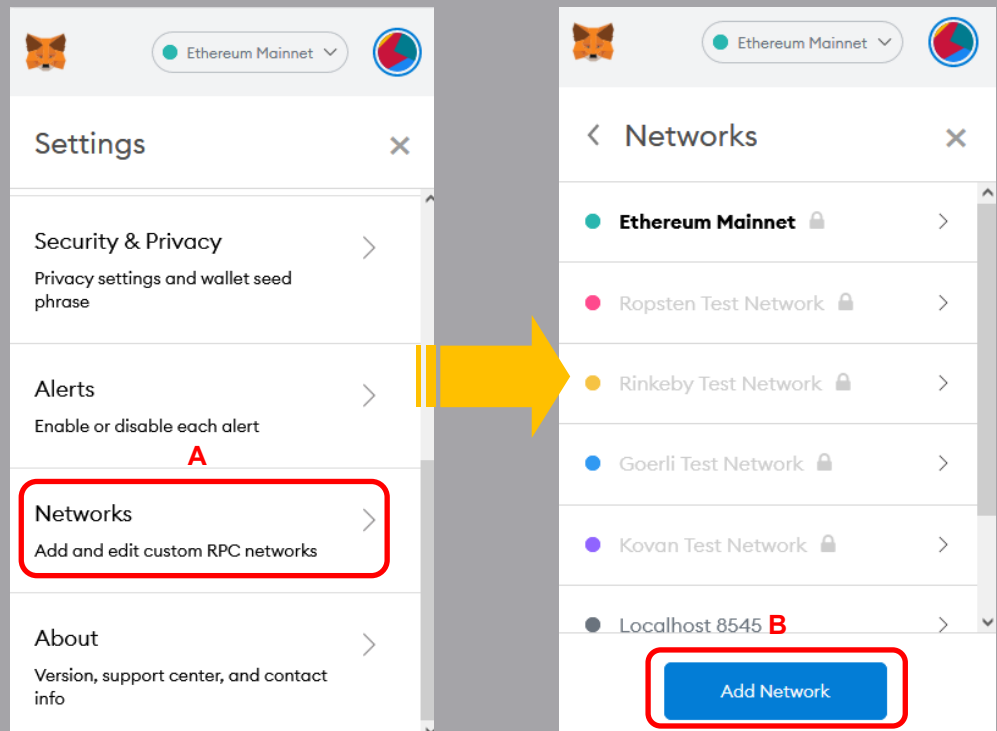

Step 3. Enter the following settings for Binance Smart Chain listed in the screenshot below and select “Save” when complete. Select the Binance Smart Chain network from the list of networks.

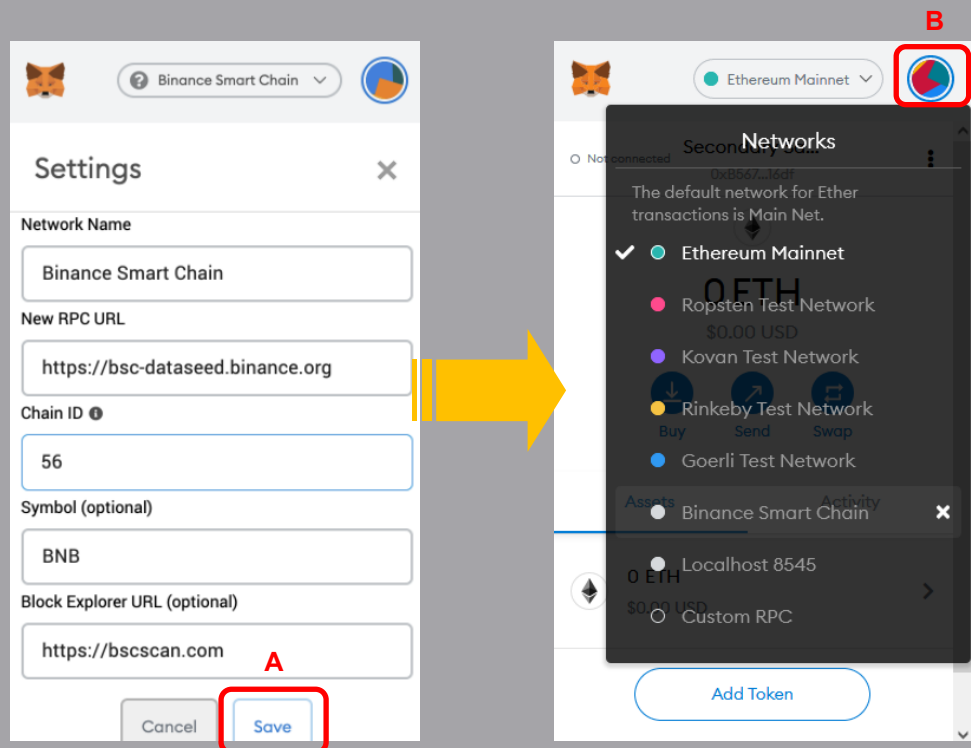

STEP 4

Add SafeDoge token

Add the SafeDoge (\$SFDoge) token to your MetaMask wallet by selecting “Add token”. Enter the SafeDoge contract address under the “Token Contract Address” section. Followed by selecting “Next” Address is listed below.

0x2e9fa3042dd76d748a25eec806fe4e4f0b6f62cd

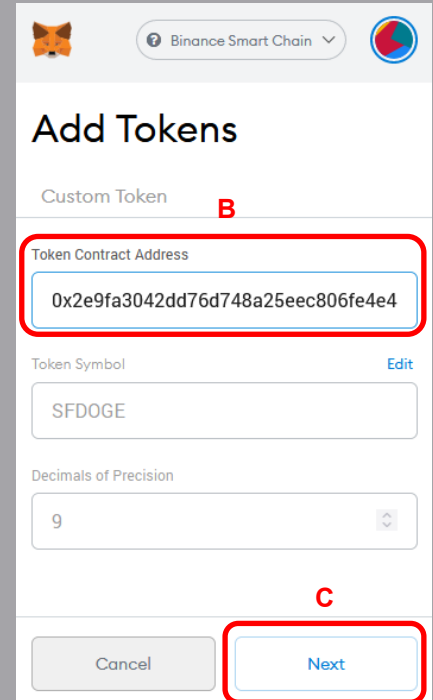
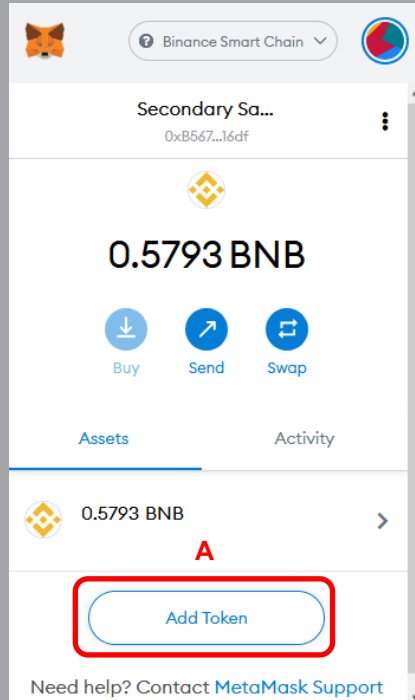

Confirm “Add Tokens” by selecting “Add Tokens”. The SafeDoge contract is now visible in your MetaMask wallet.

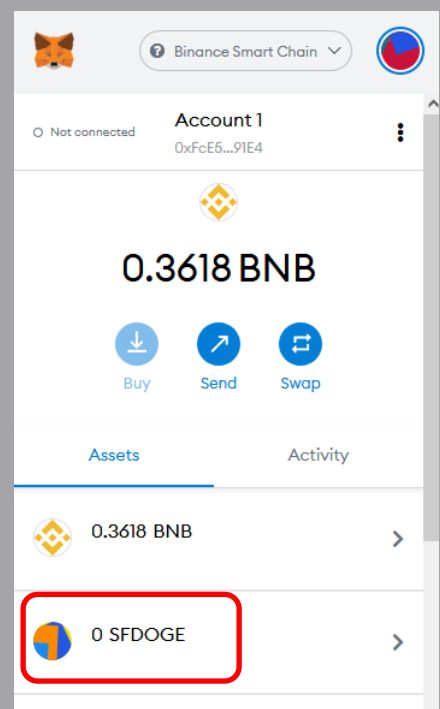
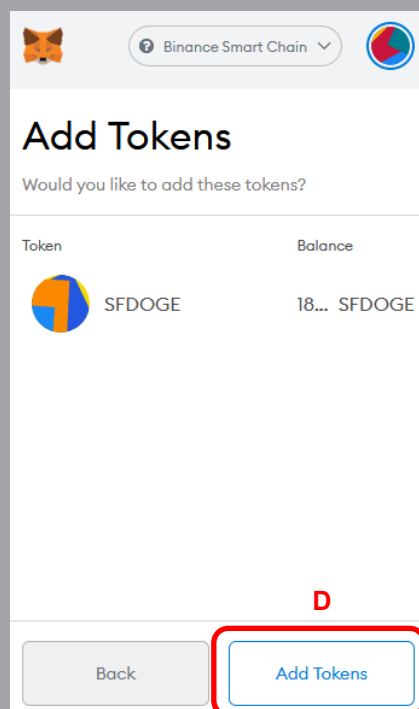

STEP 5

Withdraw BNB coins

You will need to withdraw your BNB coins from the exchange you purchased them from and transfer those to your MetaMask wallet*. Methods vary between exchanges, see your exchange for instructions on withdrawing coins. Use your MetaMask public key (listed at the top of the wallet) for sending the BNB from the exchange to your wallet.

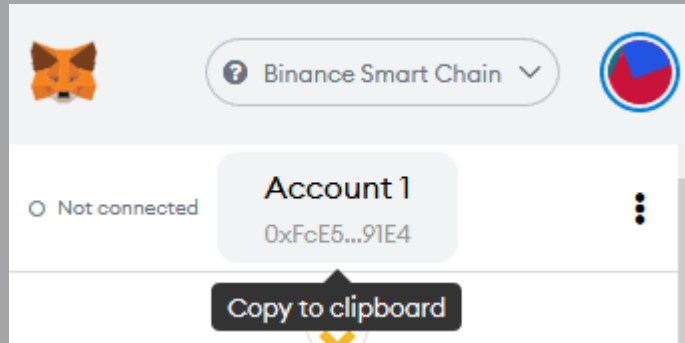

*exchange withdrawals could take up to several minutes to a few hours depending on the exchange

STEP 6

Visit PancakeSwap

Now that you have BNB available within your MetaMask wallet, you can exchange BNB coin for SafeDoge (\$SFDOGE) by visiting the DeFi PancakeSwap exchange.

<https://exchange.pancakeswap.finance/#/swap?&outputCurrency=0x2e9Fa3042Dd76D748a25Eec806fe4e4f0B6f62cd>

Or clicking the “Buy \$SFDOGE” link on <https://safedoge.live> website

You may be prompted to import token. Select “I understand” and press “Import”

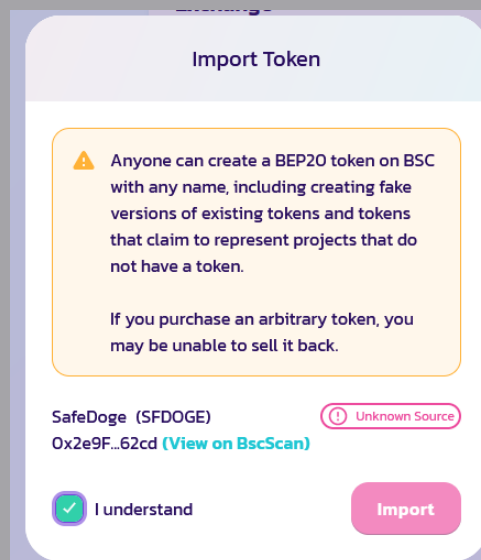

STEP 7

Swap BNB

Enter the amount of BNB you wish to swap for SFDOGE (this is equivalent to purchasing SFDOGE with a market order)

Before swapping BNB for SFDOGE, the slippage tolerance needs to be adjusted to cover the additional transaction fees of SFDOGE (5% redistribution fee, 3% donation, 2% burn fee and 2% slippage)

Exchange
Trade tokens in an instant

From: 0.1 BNB (Balance: 0.361758)

To (estimated): 126272000000 SFDOGE (Balance: 0)

Price: 0.000000000000791935 BNB per SFDOGE

Swap

Minimum received: 125600000000 SFDOGE
Price Impact: 1.51%
Liquidity Provider Fee: 0.00025 BNB

Settings

Transaction Settings

Slippage tolerance: 0.1%, 0.5%, 1%, **12%**

Your transaction may be frontrun

Transaction deadline: 20 minutes

Interface Settings

Toggle Expert Mode:

Disable Multihops:

Audio:

When ready select “Swap” and confirm the transaction by selecting “Confirm Swap” when prompted. You will then be prompted by MetaMask to sign the transaction.

Confirm Swap

0.1 BNB

126272000000 SFDOGE

Output is estimated. You will receive at least 112743000000 SFDOGE or the transaction will revert.

Price: 12627300000000 SFDOGE / BNB

Minimum received: 112700000000 SFDOGE

Price Impact: 1.51%

Liquidity Provider Fee: 0.00025 BNB

Confirm Swap

Binance Smart Chain

Account 1 → 0x10ED...02...

https://exchange.pancakeswap.finance

SWAP EXACT ETH FOR TOKENS

0.1

DETAILS DATA

GAS FEE: 0.001295
No Conversion Rate Available

Gas Price (GWEI): 5 Gas Limit: 259026

AMOUNT - GAS FEE

TOTAL: 0.101295
No Conversion Rate Available

Reject **Confirm**

If the transaction was successful you will now have SFDOGE in your MetaMask wallet!

STEP 8

Complete

You have now successfully purchase SafeDoge (SFDOGE). For any questions please contact the SafeDoge team via any of the following links

Twitter: https://twitter.com/_safedoge

Telegram: <https://t.me/s/SFDogeToken>

Reddit: <https://www.reddit.com/r/SafeDogeToken/>

Email: safedoge75@gmail.com

Or visit our website for more details about the SafeDoge project (<https://safedoge.live>)

